



# REPLACING THE BACKREST ACTUATOR

It is imperative that Human Touch<sup>®</sup> products are repaired in a manner that ensures product safety and regulatory compliance and that is fully consistent with the practices used during the manufacturing process. Therefore, Human Touch requires that all product repairs are performed using only factory-new parts and in accordance with these repair instructions. Failure to adhere to these instructions voids the product warranty and releases Human Touch from all liability for injury or product damage resulting from the repair.

SERVICE LEVEL: 3

**Tools Required:** Phillips-head screwdriver, 3mm Allen key, pliers, hammer. **NOTE:** SAVE ALL SCREWS FOR USE DURING REASSEMBLY.



**CAUTION!** You will need at least two people to complete this procedure, as the chair is very heavy. Be sure you have enough people to lift and move the chair, to prevent injury.



(Fig.1)

## GET READY

1. Plug in the chair and power it on.
2. Use the remote control to fully deploy the foot and calf massager.
3. Power off the chair and unplug it.
4. Using two or more people, stand on the same side of the chair and, lifting with your knees, turn the chair gently on its side (Fig.1).

## REMOVING THE RECLINE ACTUATOR

### DISCONNECT THE RECLINE ACTUATOR

1. Remove the two screws from the cover of the junction box, using a Phillips-head screwdriver (Fig.2).
2. Remove the cables leading to the actuator by sliding them out of the slots, then disconnect the connectors.

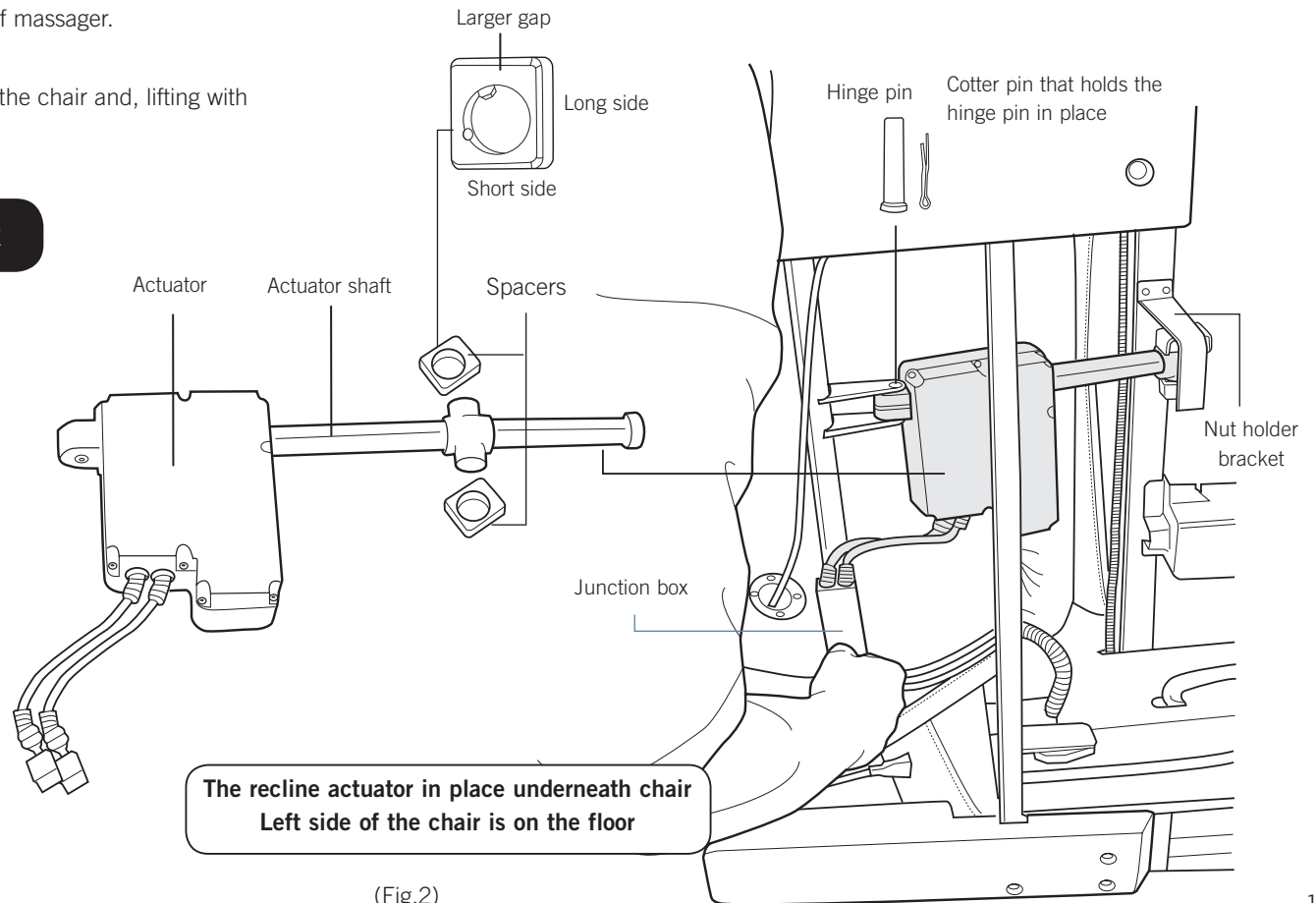

(Fig.2)

## REMOVE THE RECLINE ACTUATOR

1. Remove the cotter pin using a pliers, by straightening out the two ends of the cotter pin and pulling it through the hinge pin (Fig.2).
2. Remove the hinge pin using a pliers (or small hammer if necessary) to free it from the hinge. Leave the recline actuator in the hinge.
3. Locate the screws on the top and bottom of the nut holder bracket that holds the end of the actuator shaft. Remove both screws using a 3mm Allen key (Fig.3). This frees the shaft bracket.
4. Remove the shaft bracket from the nut holder bracket (Fig.3).
5. Remove the actuator shaft from the nut holder bracket by sliding the shaft toward the bottom of the chair as far as it will go.
6. Rotate the spacers 45 degrees to the left to assist in removing them from the nut holder bracket hinges (Fig.4).
7. Standing with your hip against the backrest to support it, remove the actuator from the hinge.

**Note:** The hinge and recline actuator hold the backrest in place. When the actuator is removed from the hinge, the backrest moves freely.

8. Pull the shaft out of the nut holder bracket, and remove the entire actuator assembly from the chair.

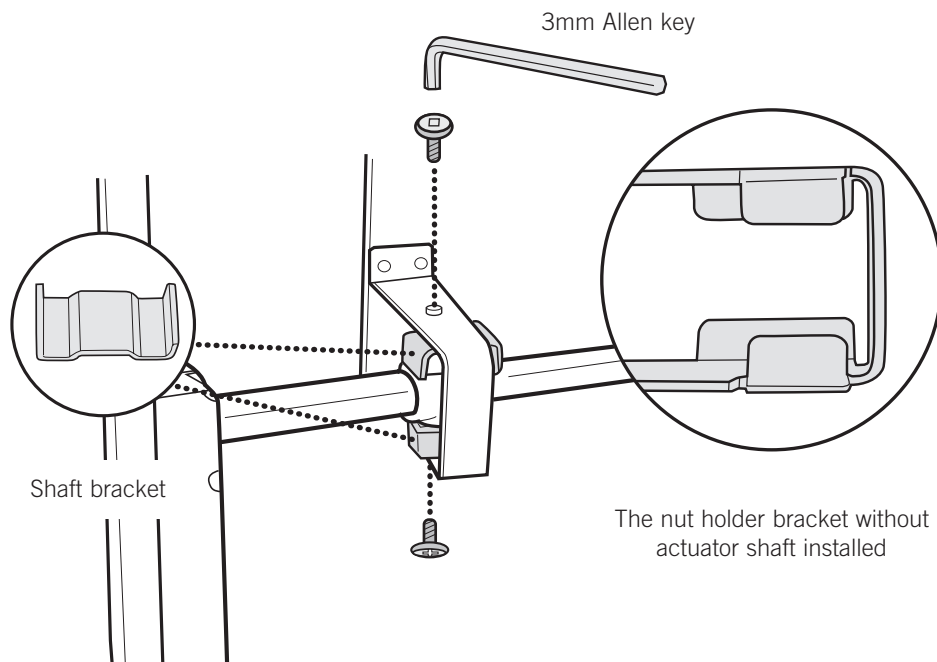

(Fig.3)

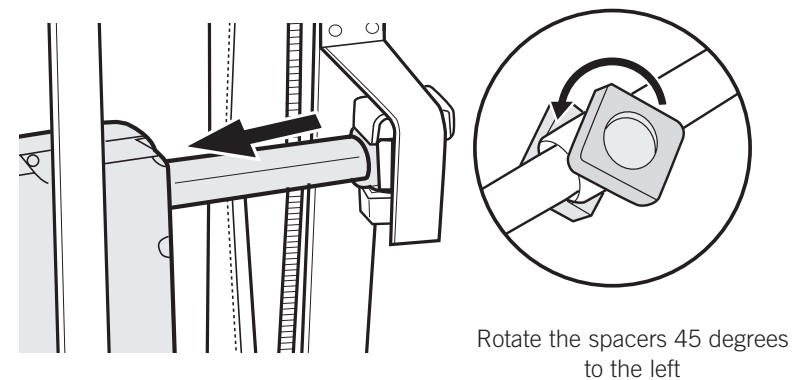

(Fig.4)

## INSTALLING THE BACKREST ACTUATOR

1. Place the spacers on the actuator shaft. Make sure that the larger gap on the spacer is on the same side for both spacers and facing toward the end of the shaft (Fig.5).  
**Note:** It is important that the larger gap of the spacers is facing the floor when the chair is in its normal position. Starting this way and following the instructions will ensure that occurs.
2. Insert the actuator shaft into the nut holder bracket as far as it will go. Rotate the spacers 45 degrees to the right, then move the shaft into place (Fig.5).
3. Position the actuator into the hinge.
4. Slide the shaft bracket into the nut holder bracket.
5. Replace the screws on the top and bottom of the nut holder bracket using a small Phillips-head screwdriver.
6. Replace the hinge pin, with the hole on top. Use a small hammer if necessary to move the pin into place.
7. Replace the cotter pin using a pliers. Bend the ends of the cotter pin back toward the hinge pin, until they touch the pin. This prevents the ends of the pin from cutting the leather on the bottom of the chair.
8. Reconnect the two cables near the junction box, then position the cables into the junction box slots.
9. Replace the cover on the junction box, then replace the two screws using a Phillips-head screwdriver.
10. Using two people, return the chair to its upright position.

## TEST THE BACKREST ACTUATOR

1. Plug in the chair and power it on.
2. Use the remote control to recline the chair (Fig.6).

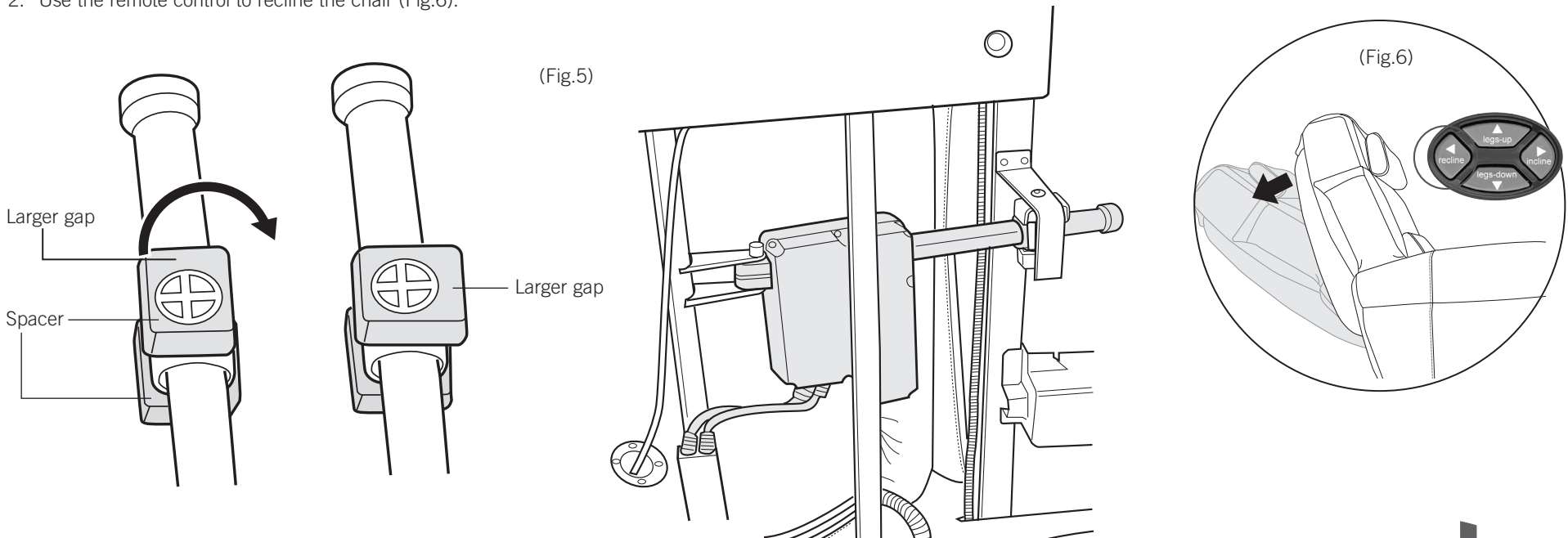

Please send any questions or comments regarding these instructions to: [documentation@humantouch.com](mailto:documentation@humantouch.com)

© 2010 Human Touch™, LLC.