



# REPLACING THE BACKREST

To ensure that Human Touch<sup>®</sup> products are repaired in a manner that is fully consistent with the practices used during the manufacturing process, Human Touch requires that all product repairs are performed using only factory-new parts and in accordance with these product repair instructions.

SERVICE LEVEL: 3

**Tools Required:** 3/16 Allen key, 3 mm Allen key, Phillips-head screwdriver, Flat-head screwdriver, small hammer, Nail clipper or other instrument suitable for cutting zip ties, new zip ties.

**NOTE:** SAVE ALL SCREWS FOR USE DURING REASSEMBLY.

## REMOVING THE BACKREST

### GET READY

1. Use the remote to fully deploy the foot and calf massager to a horizontal position (Fig.1).
2. Power off the chair and unplug it.
3. Remove the backrest pad and the seat pad from the chair (Fig.1) (see *Use and Care manual* for more information).
4. Gently tip the chair onto its side (Fig.2).

### DISCONNECT THE CONNECTORS

1. Using a Phillips-head screwdriver, remove the three screws that secure the connector junction box cover, then remove the cover (Fig.2).
2. Disconnect all three connectors (Fig.2).
3. Gently return the chair to the upright position.



(Fig.1)

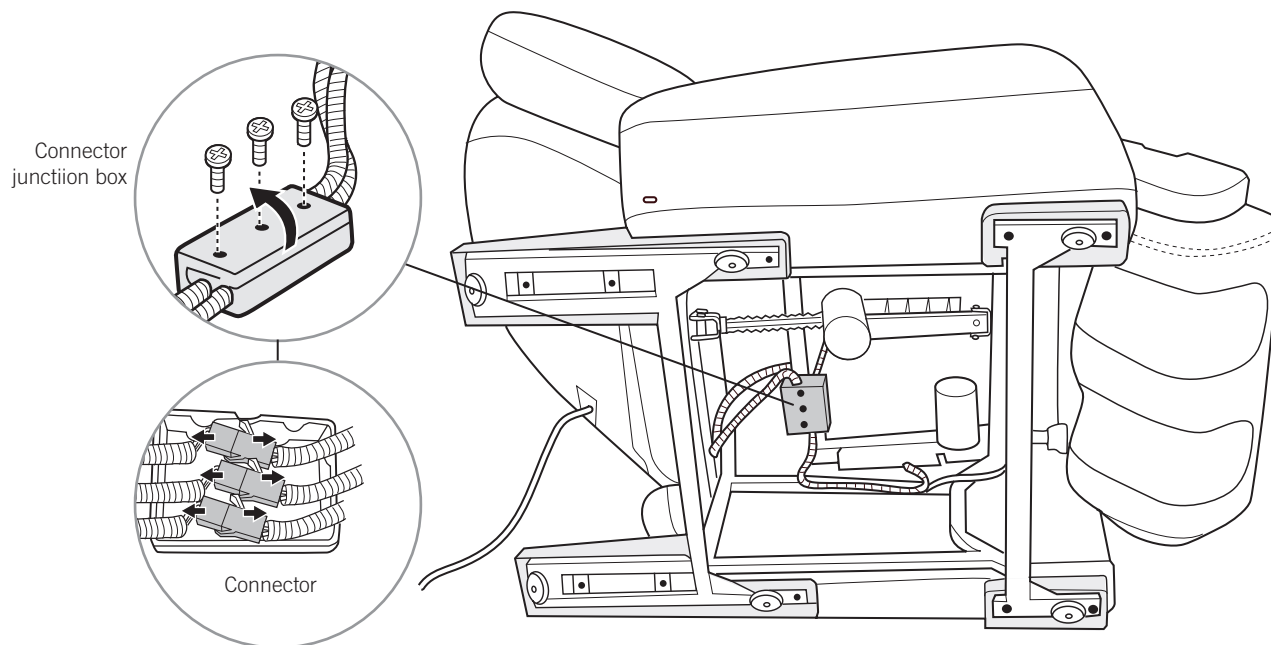

(Fig.2)

## REMOVE BOTH ARMRESTS

1. Using a 3/16-inch Allen Key, remove the two screws/washers that secure the armrest to the chair (Fig.3).
2. Pull the armrest straight up until the mounting posts on the lower inside edge of the armrest clear the mounting post guides, then remove the armrest from the chair (Fig.4).
3. Repeat steps 1 and 2 to remove the other armrest from the chair.

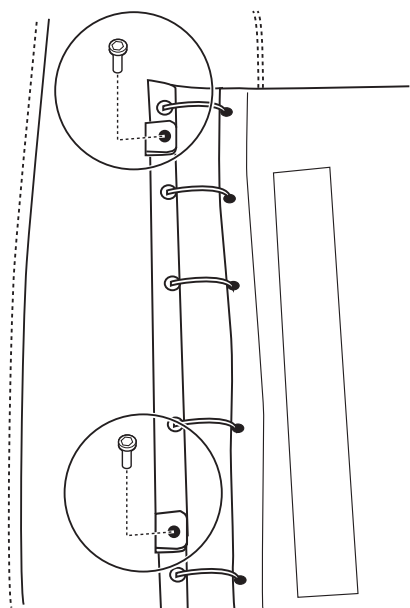

(Fig.3)

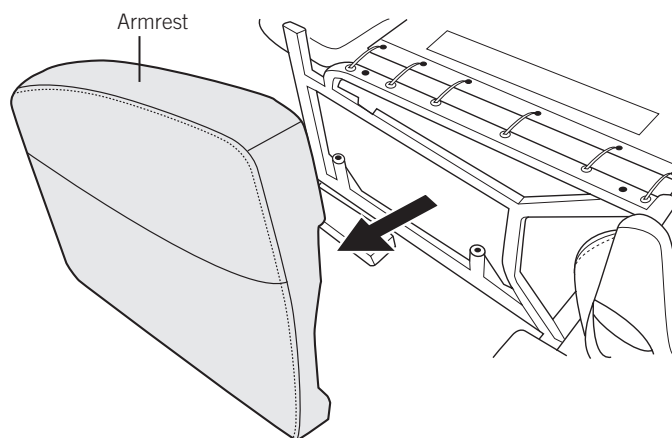

(Fig.4)

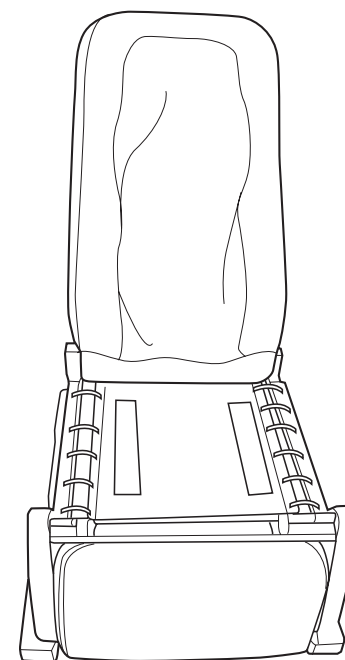

(Fig.5)

## REMOVE THE BACKREST HINGE PINS

1. Press down on the backrest release lever on the back of the chair to release the backrest from the backrest actuator.
2. Fold the backrest forward onto the chair seat.
3. Using a 3 mm Allen key, remove the Allen screw from the backrest hinge on one side of the chair (Fig.6).
4. Using a flat-head screwdriver, pry the hinge pin head away from the chair frame, then remove the hinge pin.
5. Repeat steps 3 and 4 on the opposite side of the chair.

**IMPORTANT:** When you remove the hinge pins, the metal horizontal bar containing the backrest lever drops, along with a small black washer from each side of the backrest. Be sure to locate these washers and set them aside. A second, larger washer may also fall out of the mounting arm on each side of the backrest.

6. Remove the backrest from the chair.

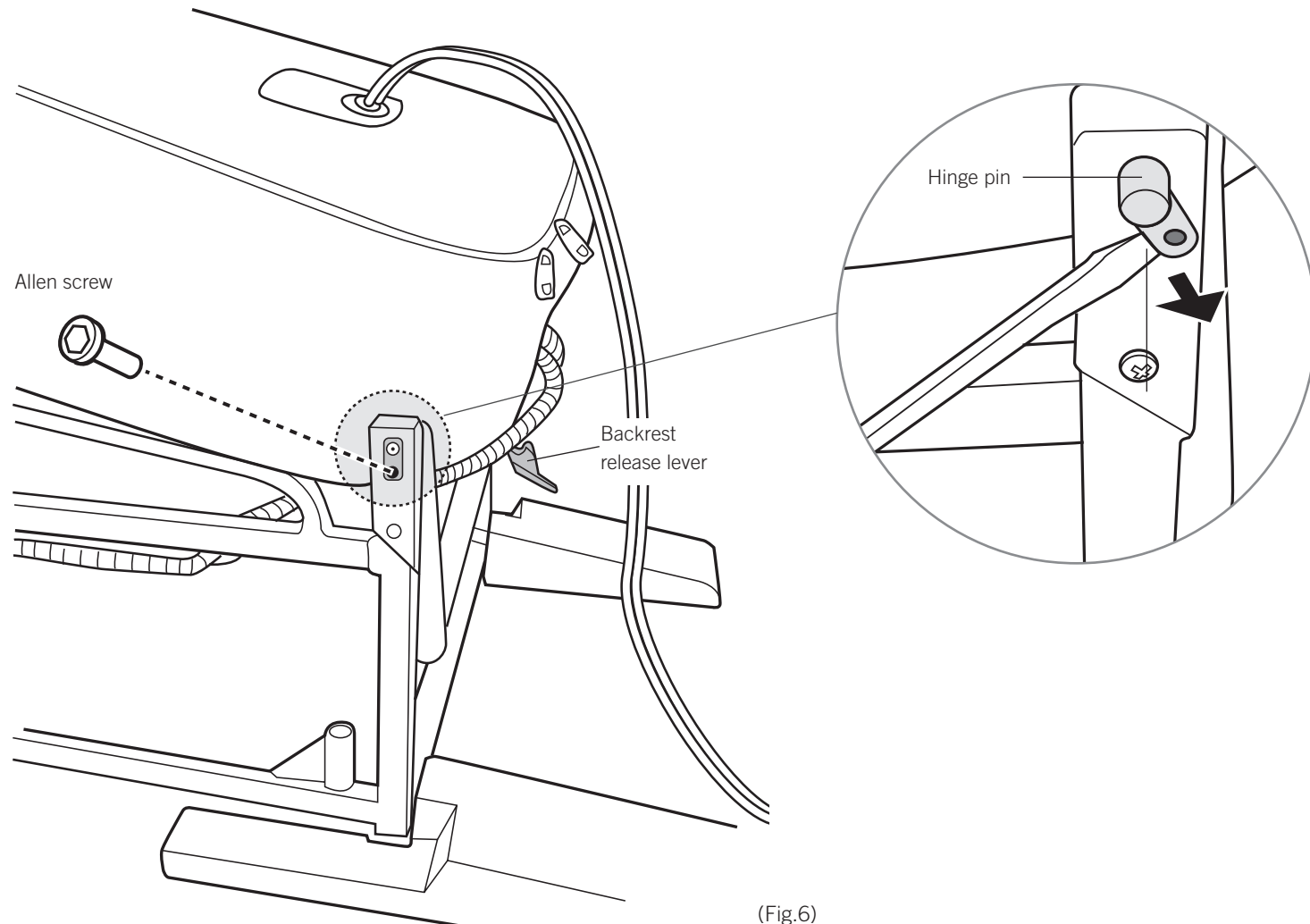

(Fig.6)

## INSTALLING THE NEW BACKREST

### INSTALL THE BACKREST HINGE PINS

1. Place the new backrest into position, on top of the chair seat.
2. Make sure the larger washer is installed in the mounting arm. This washer may have fallen out when the backrest was removed. The mounting arm washer contains a notch, which fits a corresponding notch on the mounting arm (Fig.7).
3. Raise the metal horizontal bar into position, with the mounting arm positioned between the backrest and the chair frame.
4. While pushing down on the bottom of the backrest to align the holes on each side with the corresponding holes in the chair frame, insert the hinge pin through the chair frame, the smaller washer, the mounting arm, and into the receptacle on the side of the backrest.
5. Using a small hammer, tap the hinge pin all the way into the backrest, until the pin head is flush with the chair frame.
6. Using a 3 mm Allen key, replace the Allen screw to secure the backrest to the chair frame.
7. Repeat steps 3 - 5 to install the hinge pin and Allen screw on the other side of the backrest.

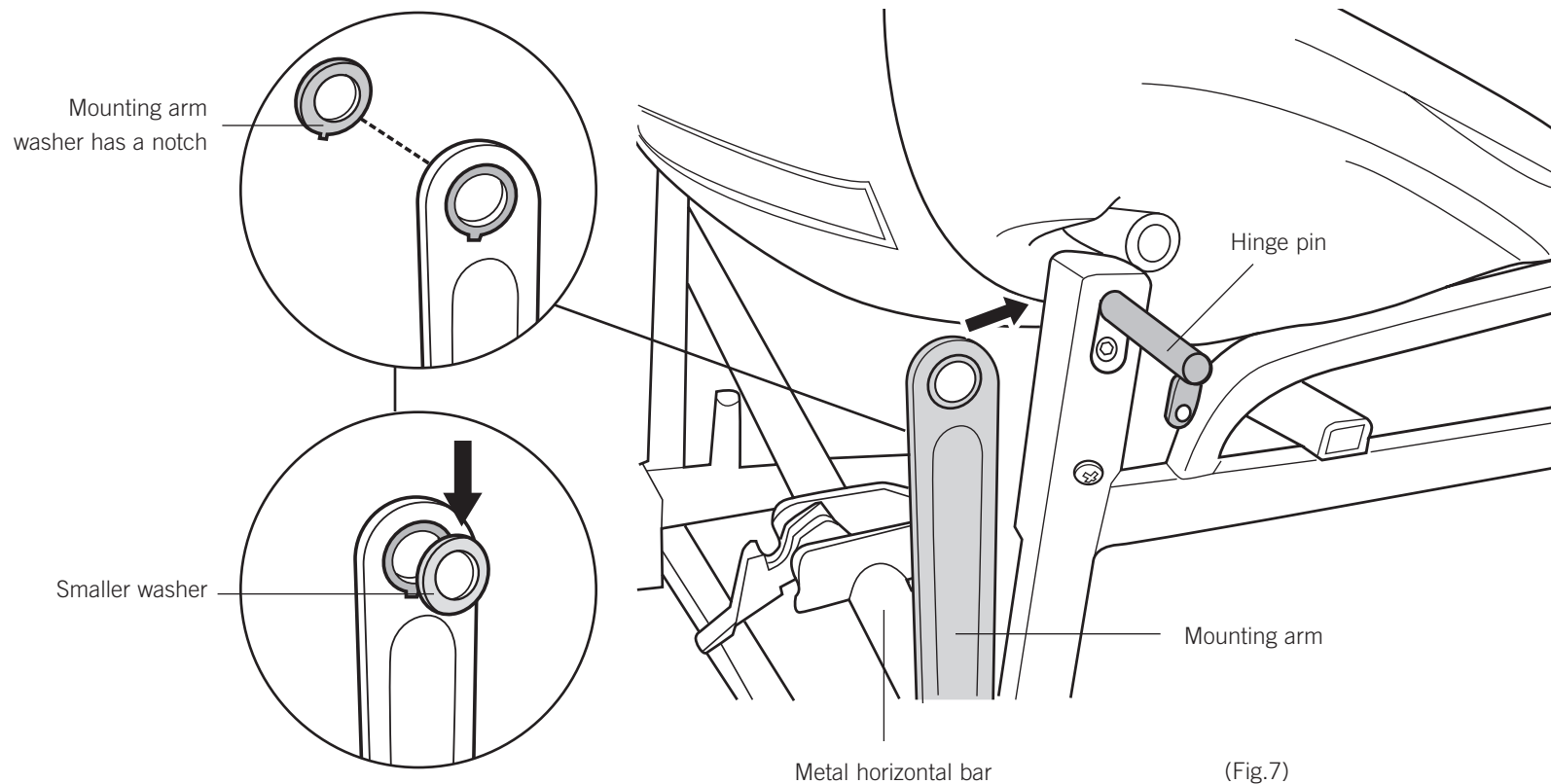

(Fig.7)

## REPLACE THE ARMRESTS

1. Insert the two mounting posts on the lower inside edge of the armrests into the two corresponding mounting post guides (Fig.8).
2. Lower the armrest into position, until the mounting brackets on the armrest meet the screw holes on the chair frame (Fig.8).
3. Replace the two screws/washers to secure the armrest to the chair (Fig.8).

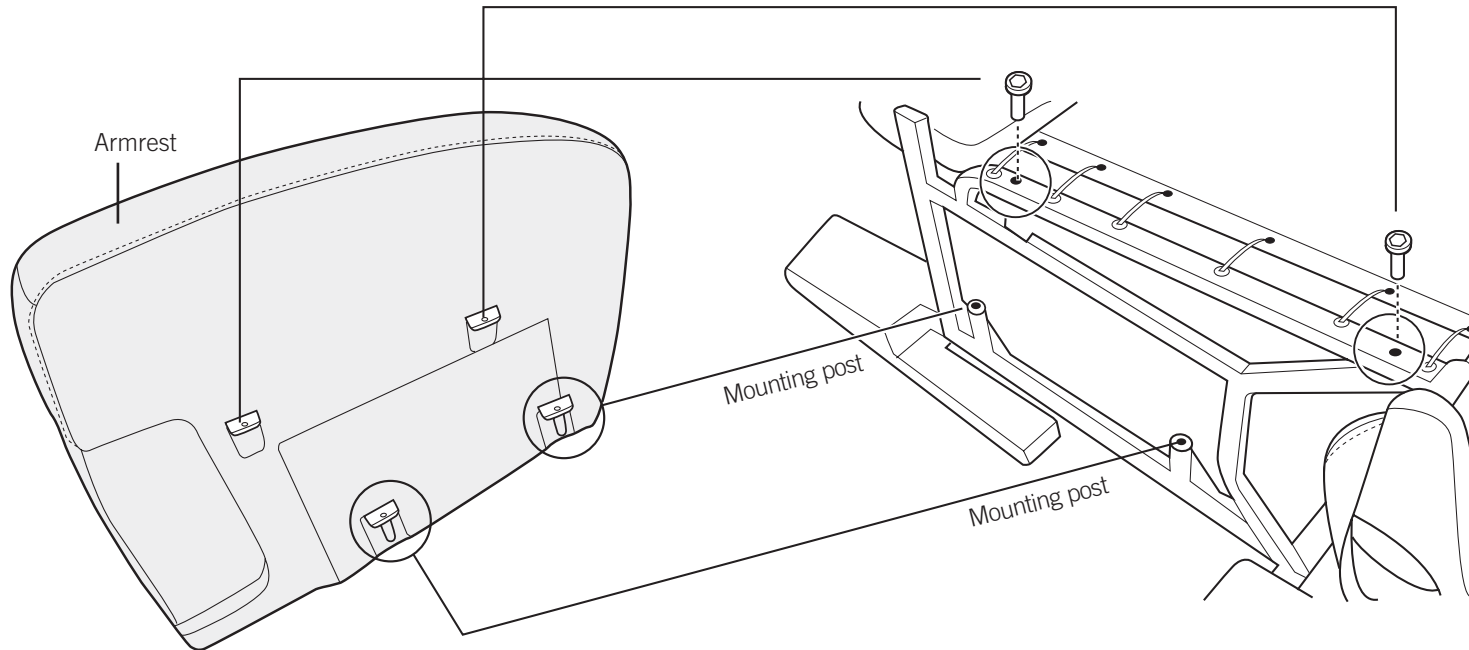

(Fig.8)

## CONNECT THE CONNECTORS

1. Gently tip the chair onto its side.
2. Connect the three backrest connectors to the corresponding connectors.
3. Arrange the connectors inside the connector junction box, position the junction box cover, then secure it using three screws.
4. Use new zip ties to secure the cable harnesses to the chair frame.
5. Gently return the chair to the upright position.

## COMPLETE THE INSTALLATION

1. Replace the seat pad and backrest pad.
2. Plug in the chair, power it on, and verify that all massage functions are now working properly.

Please send any questions or comments regarding these instructions to: [documentation@humantouch.com](mailto:documentation@humantouch.com)

© 2008 Human Touch®, LLC.