

## REPLACING THE AIR PUMP

To ensure that Human Touch® products are repaired in a manner that is fully consistent with the practices used during the manufacturing process, Human Touch requires that all product repairs are performed using only factory-new parts and in accordance with these product repair instructions.

SERVICE LEVEL: 2

Tools Required: Phillips-head screwdriver, 5/32-inch (4 mm) Allen key, nail clipper or other instrument suitable for cutting zip ties

NOTE: SAVE ALL SCREWS FOR USE DURING REASSEMBLY.

⚠ CAUTION! You will need at least two people to complete this procedure, as the chair is very heavy. Be sure you have enough people to lift and move the chair, to prevent injury.

### REMOVING THE AIR PUMP

1. Power off the chair and unplug it.
2. Using two people, tip the chair gently onto its right-hand side.
3. Using a 5/32-inch (4 mm) Allen key, remove the four screws from the backrest cover.
4. Tip the backrest cover backward to expose the three connectors at the bottom, disconnect the three connectors, then remove the backrest cover.

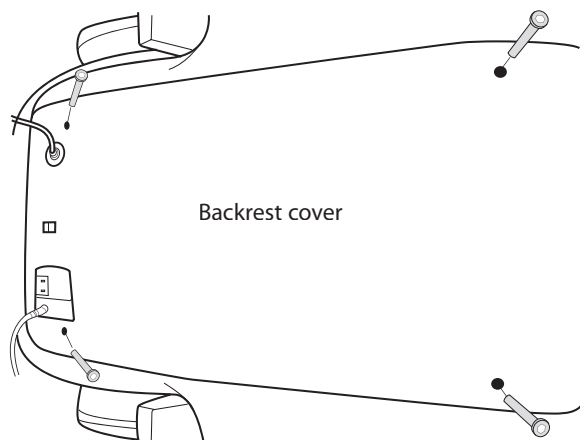

(Fig.1)

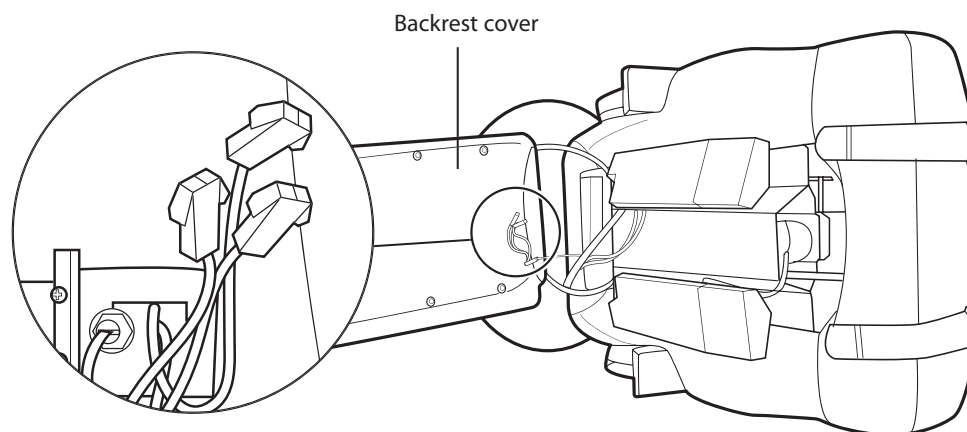

(Fig.2)

5. Locate the two air pump tube connections to the backrest (Fig.3).
6. Mark each tube and its corresponding fitting, to use as reference when connecting the tubing from the new air pump. The tubes must be connected to the correct fitting.
7. Using a nail clipper (or other instrument suitable for cutting zip ties), cut the zip ties that secure the two tubes to the backrest, then remove the tubes from the backrest.
8. Using a nail clipper (or other instrument suitable for cutting zip ties), cut the zip ties that secure the air pump tubing to the chair frame.
9. Locate the small connector junction box toward the front of the chair frame, cut the zip ties that secure the box cover, then use your fingers to pop it open.
10. Disconnect the connectors inside the junction box.
11. Cut any zip ties that secure the cable harnesses to the chair.
12. Locate the air pump on the bottom of the chair, then remove the six sets of screws/washers that secure the pump to the chair (Fig.4).  
 IMPORTANT NOTE: Each screw has two rubber washers on the visible side and one rubber washer on the back side of the mounting bracket. Be sure to retail all washers for use during reassembly.
13. Remove the air pump and tubing from the chair.

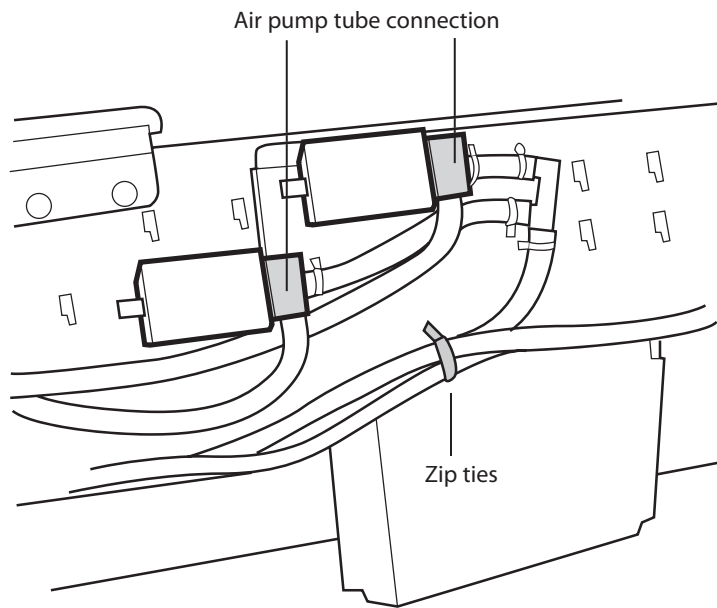

(Fig.3)

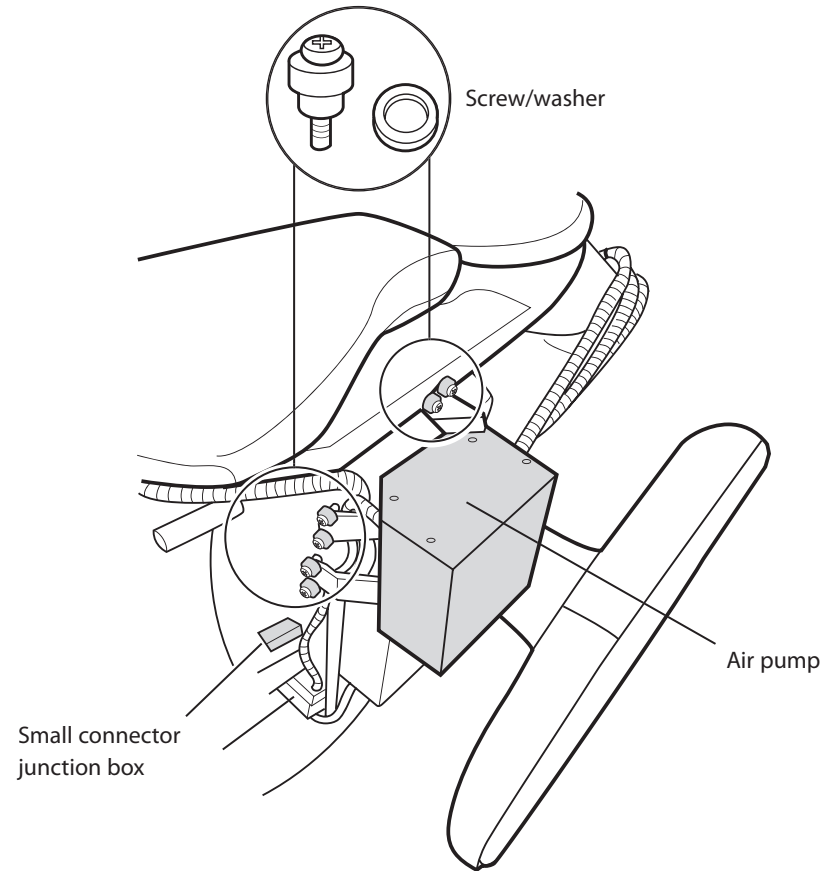

(Fig.4)

## INSTALLING THE NEW AIR PUMP

1. Compare the tubing on the old air pump with the tubing on the new air pump, and mark the new tubing to match the old. This will ensure that you connect the tubing to the correct fitting on the backrest.
2. Place the new air pump into position, and secure it using the six screws/washers you removed earlier. Be sure to position the washers as shown (Fig.5).
3. Connect the air pump connectors, then position them inside the connector junction box.
4. Snap the two sides of the junction box together, then secure them using a new zip tie.
5. Connect the two air pump tubes to the backrest, as shown (Fig.3).
6. Place the backrest cover into position, then reconnect the three connectors at the bottom (Fig.2).
7. Using a 5/32-inch (4 mm) Allen key, replace the four backrest screws.  
NOTE: Be sure to use the two longer screws in the upper screw holes and the two shorter screws in the lower screw holes.
8. Use new zip ties to secure the cable harnesses to the chair frame.
9. Using two people, tip the chair gently to an upright position.
10. Power on the chair and test the massage comfort control to ensure that it is now working.

