

REPLACING A FOOT AND CALF MASSAGER SIDE PANEL

To ensure that Human Touch® products are repaired in a manner that is fully consistent with the practices used during the manufacturing process, Human Touch requires that all product repairs are performed using only factory-new parts and in accordance with these product repair instructions.

SERVICE LEVEL: 1

1. Pull outward on the foot and calf massager side panel to remove it (Fig.1).
2. Align the mounting posts on the new side panel cover with the corresponding mounting post guides on the footrest.
3. Push the new side panel firmly into place (Fig.2).
4. Pull gently outward on the cover to ensure that it is secure.

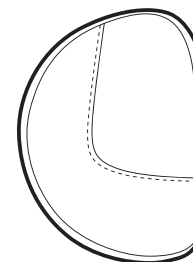

Foot and calf massager side panel

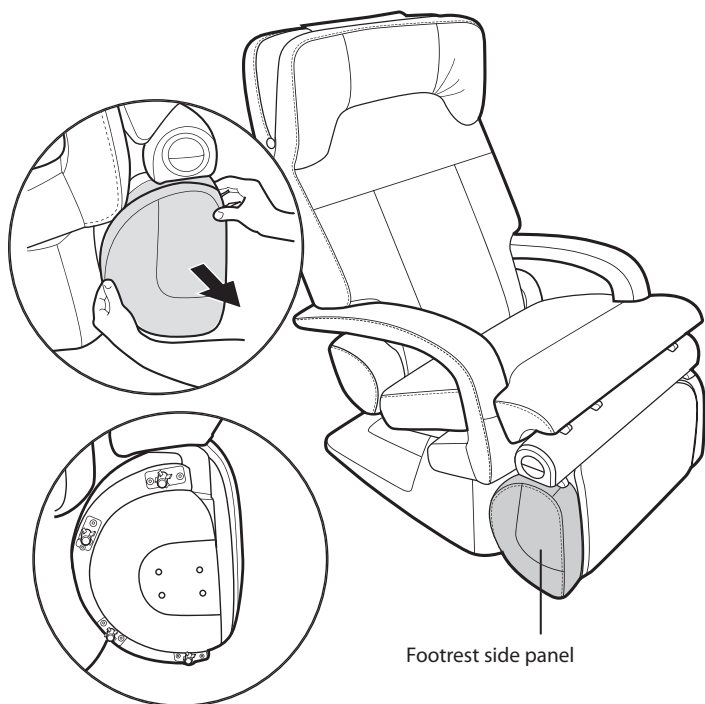

(Fig.1)

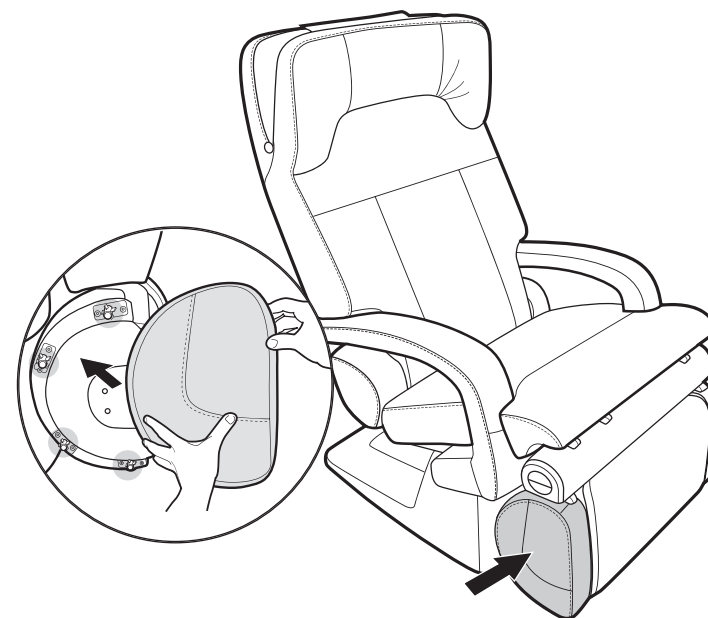

(Fig.2)