

REPLACING THE CHAIR SIDE PANELS

To ensure that Human Touch[®] products are repaired in a manner that is fully consistent with the practices used during the manufacturing process, Human Touch requires that all product repairs are performed using only factory-new parts and in accordance with these product repair instructions.

SERVICE LEVEL: 1, 3

Tools Required: Phillips-head screwdriver

REPLACING A PLASTIC SIDE PANEL

1. Pull outward on the plastic side panel to remove it from the chair base (Fig.1).
2. Push the new side panel into place (Fig.2).
3. Pull gently outward on the panel to ensure that it is secure.

REPLACING THE RIGHT-HAND UPHOLSTERED SIDE PANEL

1. Pull outward on the side panel to remove it from the chair base (Fig.1).
2. Align the posts on the chair base with the corresponding post guides on the side panel, then gently tap the new panel into place (Fig.2).
3. Pull gently outward on the panel to ensure that it is secure.

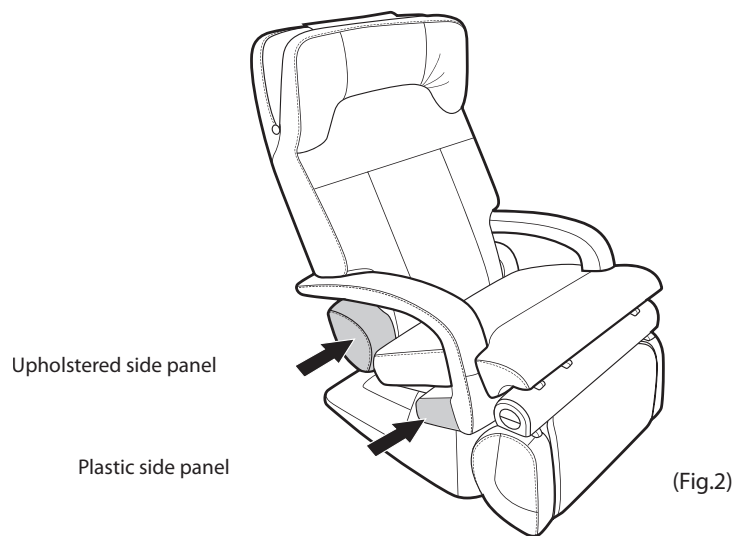
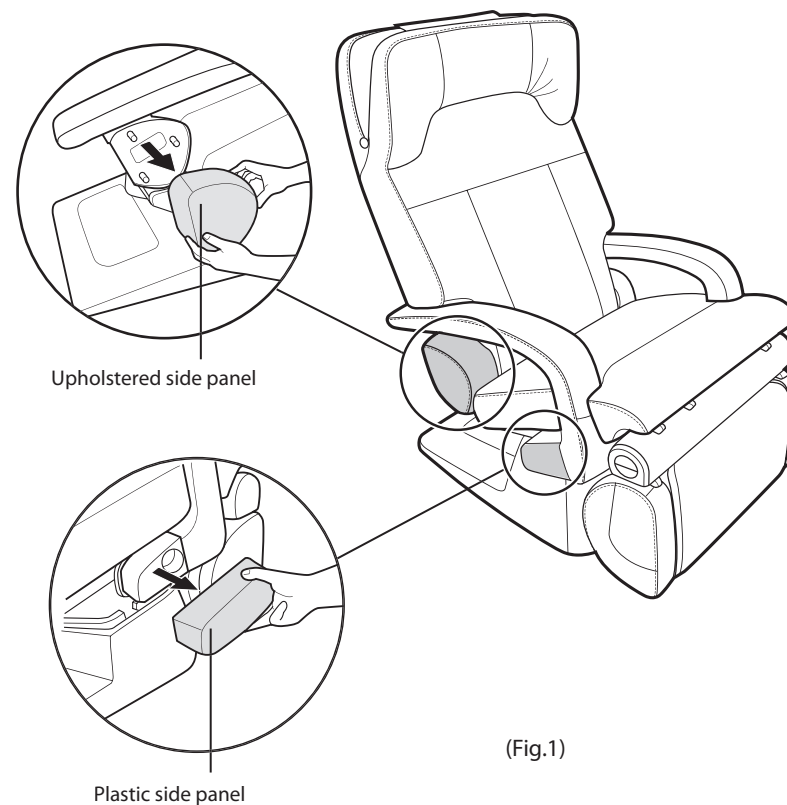

REPLACING THE LEFT-HAND UPHOLSTERED SIDE PANEL

REMOVING THE SIDE PANEL

1. Remove the three backrest connectors from the back of the left-hand side panel (Fig.3).
2. Using a Phillips-head screwdriver, remove the two screws that secure the remote control to the side panel (Fig.4).
3. Pull the remote control cable outward just enough to expose the connectors, then disconnect the connectors.
4. Using two hands, pull outward on the left-hand side panel to separate it from the chair.
5. Using a Phillips-head screwdriver, remove the two screws from the connector junction box, then disconnect the three sets of connectors inside.
6. Using a Phillips-head screwdriver, remove the two screws from the cable harness guide, which secures the two cable harnesses to the side panel (Fig.5).
7. Pull gently on the black tubing to remove it from the white fitting (Fig.5).
8. Remove the side panel from the chair.

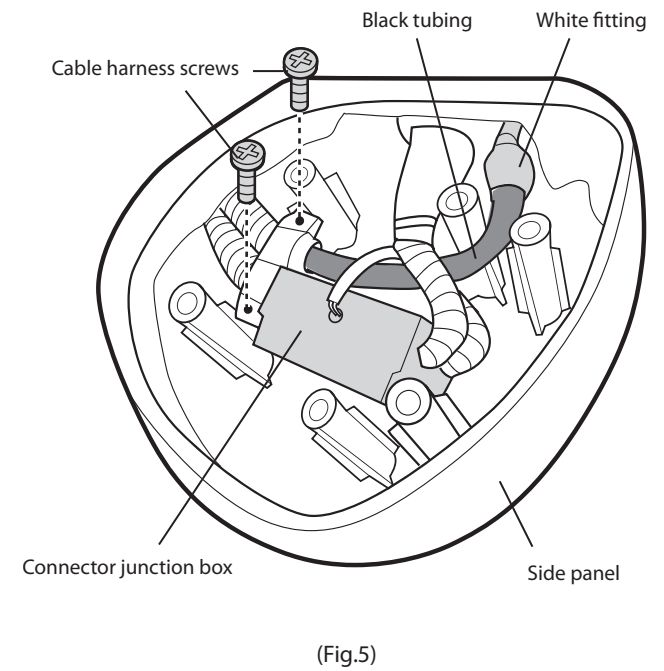
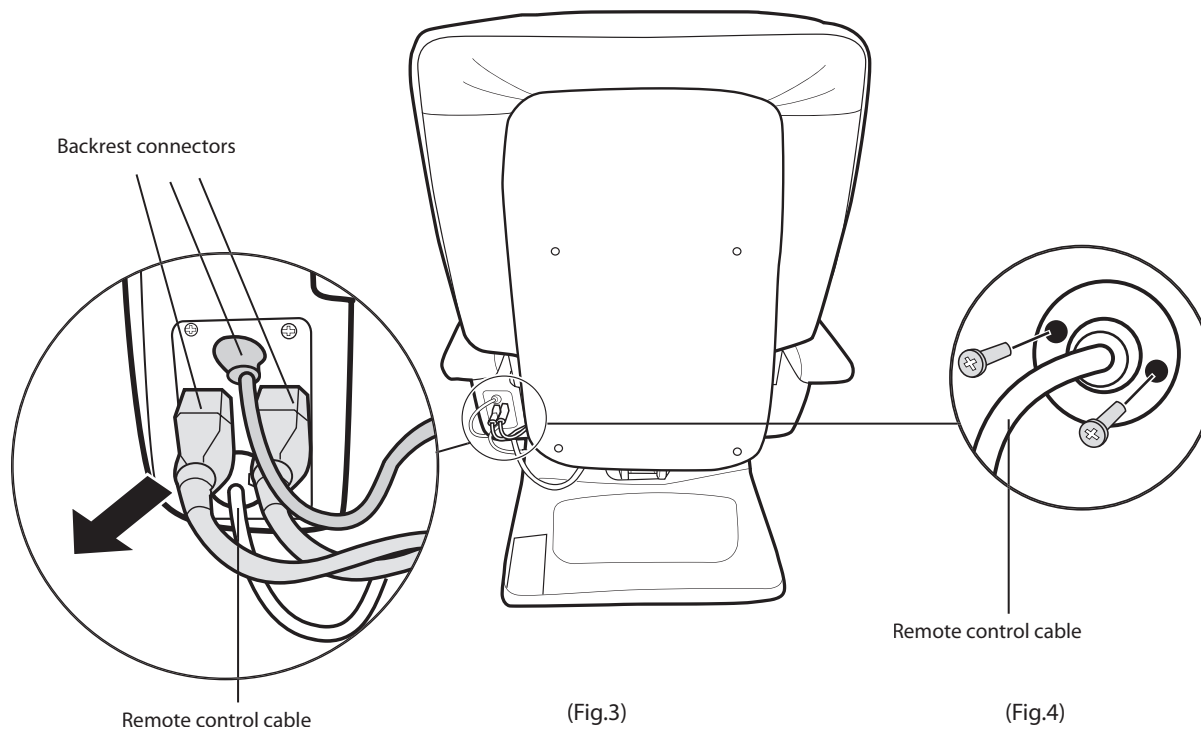

INSTALLING THE NEW SIDE PANEL

1. Holding the new side panel in position, slide the black tubing onto the white fitting.
2. Reconnect the three sets of connectors, then position the connectors inside the junction box base.
3. Secure the junction box cover to the base, using the screws you removed earlier.
4. Place both cable harnesses into their original position, then secure them in place using the cable harness guide and the screws you removed earlier.
5. Thread the remote control cable through the opening in the flat side of the side panel cover, and connect it to the corresponding cable.
6. Align the posts on the chair base with the corresponding post guides on the side panel, then gently tap the cover into place.
7. Pull gently outward on the panel to ensure that it is secure.
8. Using a Phillips-head screwdriver and two screws, secure the remote control bracket to the back of the side panel.
9. Reconnect the three backrest connectors to the back of the side panel.