



REPLACING THE WHEEL/AXLE

To ensure that Human Touch® products are repaired in a manner that is fully consistent with the practices used during the manufacturing process, Human Touch requires that all product repairs are performed using only factory-new parts and in accordance with these product repair instructions.

SERVICE LEVEL: 1

Tools Required: flat-head screwdriver

SAVE ALL REMOVED PARTS FOR USE DURING REASSEMBLY

REMOVING THE WHEEL AND AXLE

1. Using two people, tip the chair gently onto its side.
2. Holding the wheel with one hand, insert the screwdriver between the axle and the mounting groove (Fig.1).
3. Use the screwdriver as leverage to pry the axle from the groove, freeing the wheel and axle from the chair (Fig.2).

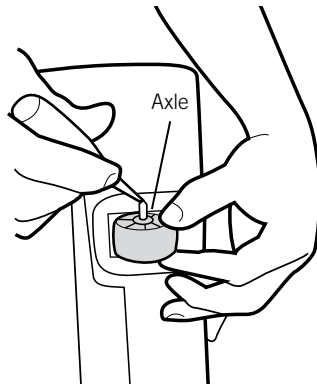

(Fig.1)

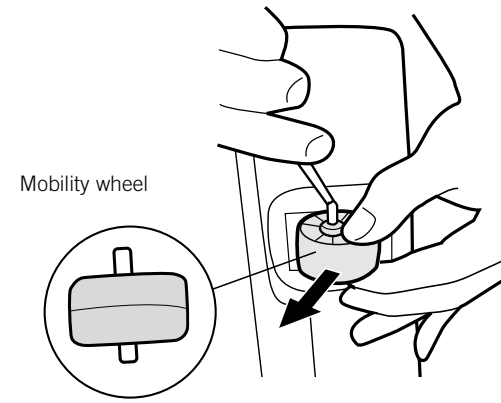

(Fig.2)

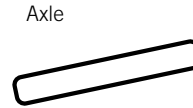

Axle

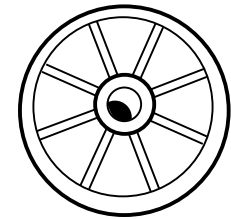

Mobility wheel

INSTALLING THE NEW WHEEL AND AXLE

1. Insert the axle through the wheel, then insert the right-hand end of the axle into the hole on the right-hand side of the wheel well.
2. Align the left-hand end of the axle with the mounting groove on the left-hand side of the wheel well, then press firmly on the wheel to snap the axle into place.
3. Tip the chair gently back to an upright position.