

REPLACING THE FOOT AND CALF MASSAGER ACTUATOR

To ensure that Human Touch® products are repaired in a manner that is fully consistent with the practices used during the manufacturing process, Human Touch requires that all product repairs are performed using only factory-new parts and in accordance with these product repair instructions.

SERVICE LEVEL: 3

Tools Required: Small Phillips-head screwdriver, needle-nosed pliers, flat-head screwdriver, two people (to turn the chair on its side),

NOTE: SAVE ALL SCREWS FOR USE DURING REASSEMBLY.

GET READY

1. Use the remote to fully recline the backrest.
2. Power off the chair and unplug it.
3. Using two people, turn the chair gently on its right-hand side (Fig.1).

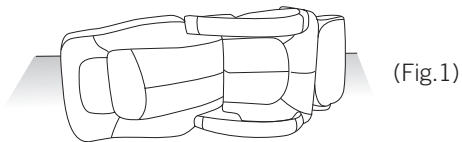

REMOVING THE ACTUATOR

1. (HT-7120 only) Locate the air pump on the bottom of the chair, use a Phillips-head screwdriver to remove the six sets of screws/washers that secure the pump to the chair, then remove the pump from the chair (Fig.2).
2. Locate the connector box on the bottom left side of the chair, near the foot and calf massager (Fig.3).
3. Using a Phillips-head screwdriver, remove the two screws that secure the connector box cover, then remove the cover (Fig.3).
4. Disconnect the white connector.

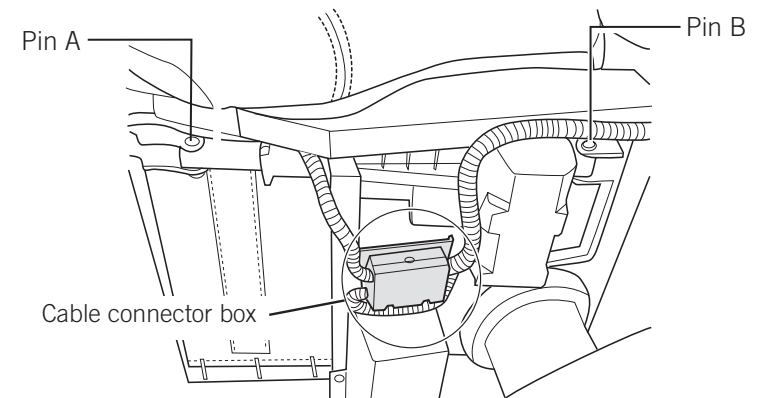
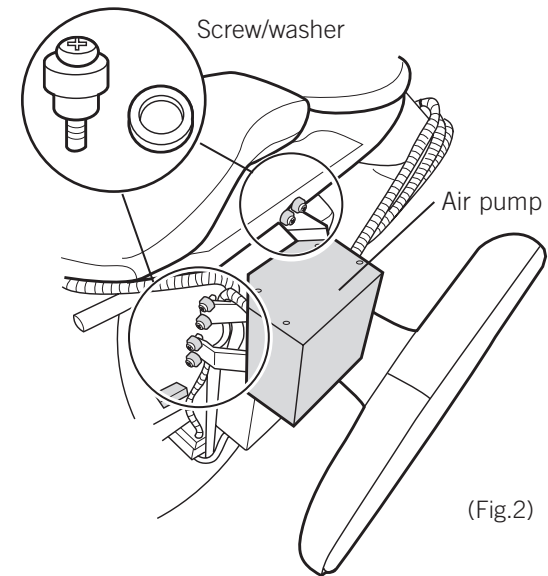

Bottom chair on side (Fig.3)

5. Locate actuator pin A (Fig. 3 & 4), then use a needle-nosed pliers or a flat-head screwdriver to pop the c-clamp off the top (Fig.4).
6. Use a flat-head screwdriver to pry the pin loose (from the bottom), then remove it (Fig.4).
7. Repeat steps 5 and 6 for actuator pin B.
8. Remove the actuator from the chair base (Fig.5).

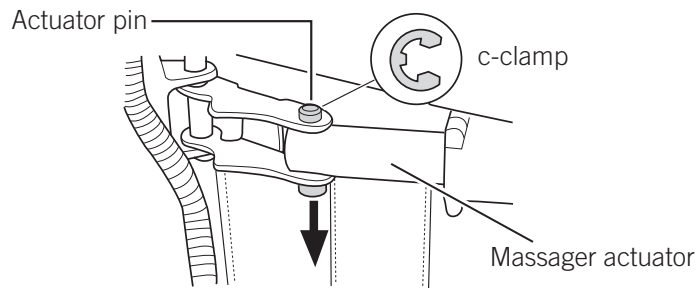

(Fig.4)

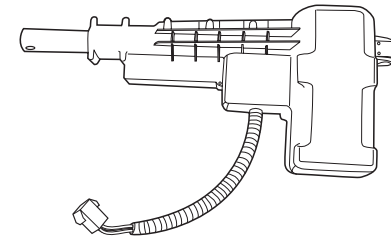

Massager actuator

(Fig.5)

INSTALLING THE NEW ACTUATOR

1. Place the actuator into position, aligning the mounting point on the back of the actuator with the corresponding bracket near the rear of the chair.
2. Insert pin B through the bracket, from the bottom up.
3. Replace the c-clamp at the top of the pin, then use a needle-nosed pliers to pinch it closed.
4. Align the mounting point on the front of the actuator with the corresponding bracket near the front of the chair.
5. Insert pin A through the bracket and the mounting point, from the bottom up.
6. Replace the c-clamp at the top of the pin, then use a needle-nosed pliers to pinch it closed.
7. Reconnect the white connectors.
8. Position both the white and red connectors inside the connector box, with the cables resting in the cable guides.
9. Replace the connector box cover, using a small Phillips-head screwdriver and the two screws you removed earlier.
10. Place the air pump into position then secure it using the six screws/washers.